

PHYSICAL CHARACTERISTICS							DECLARED DISTANCES			
RWY	DIRECTION GEO	DIMENSIONS (m)		SURFACE	THR COORDINATES	BEARING STRENGTH	TORA m	TODA m	ASDA m	LDA m
		RUNWAY	STRIP							
05	047.54°	1250 x 30	1370 x 300	ASPH	52°27'04.12"N 005°30'39.67"E	PCN 19/F/D/W/T	1250	1250	1250	1250
23	227.55°	1250 x 30	1370 x 300	ASPH	52°27'31.42"N 005°31'28.52"E	PCN 19/F/D/W/T	1250	1310	1310	1250

MICRO LIGHT AIRCRAFT (MLA)

RWY	DIRECTION GEO	DIMENSIONS (m) RWY	MARKING AIDS	TORA m	LDA m
05	048°	430 x 50	MLA RWY marked by red cones	320	310
23	228°			310	320

MICRO LIGHT AIRCRAFT



In front of the runway indicates the landing direction combined with a LEFTHAND circuit

WHITE



In front of the runway indicates the landing direction combined with a RIGHTHAND circuit

Visiting Micro Light Aircraft shall ask prior permission from the AD authority (TEL: 0320 288 328).

CAUTION

Grass cutting may take place at irregular times. Parts of the aerodrome unusable due to agricultural use.

In the vicinity of the helicopter aiming point helicopter training flights may take place between runway and buildings on the aerodrome.

Helicopters use grass areas I up to IV for precautionary landings.

LEGEND

- Taxi holding position marking
- Wind direction indicator

LOC LSD 109.550  
"NOT OPERATIONAL"

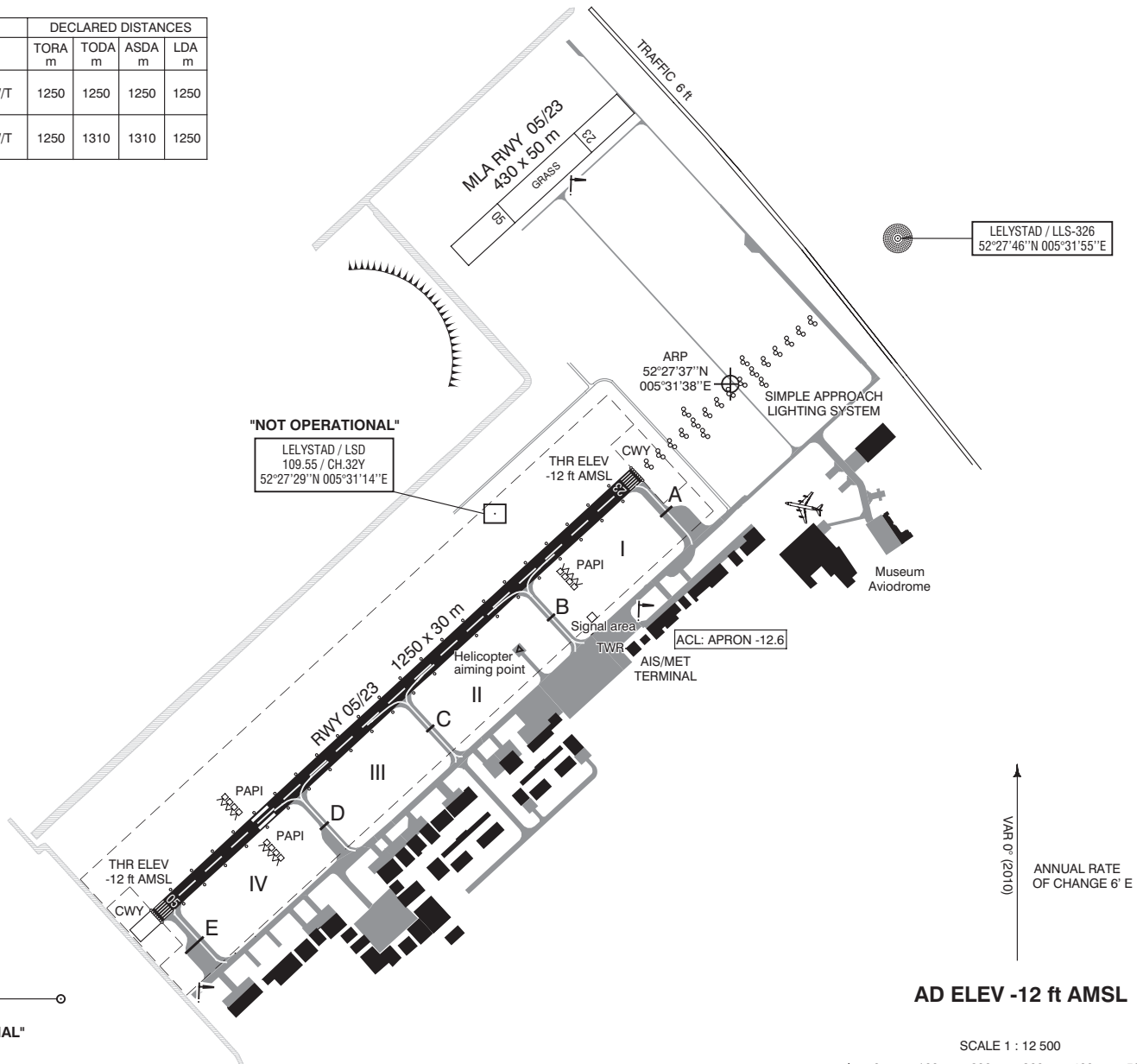

LELYSTAD / LLS-326  
52°27'46"N 005°31'55"E

"NOT OPERATIONAL"  
LELYSTAD / LSD  
109.55 / CH.32Y  
52°27'29"N 005°31'14"E

ACL: APRON -12.6

VAR 0° (2010)  
ANNUAL RATE OF CHANGE 6" E

AD ELEV -12 ft AMSL

